

PETITION REQUESTING A PARKING MANAGEMENT SCHEME IN AUSTIN'S LANE, ICKENHAM

Cabinet Member(s)	Councillor Keith Burrows
Cabinet Portfolio(s)	Cabinet Member for Planning, Transportation and Recycling
Officer Contact(s)	Kevin Urquhart Residents Services Directorate
Papers with report	Appendices A and B

1. HEADLINE INFORMATION

Summary	To inform the Cabinet Member that the Council has received a petition requesting the Ickenham Parking Management Scheme be extended to include Austin's Lane, Ickenham.
Contribution to our plans and strategies	The request can be considered in relation to the Council's strategy for on-street parking controls.
Financial Cost	There are no financial implications associated with the recommendations to this report.
Relevant Policy Overview Committee	Residents' and Environmental Services.
Ward(s) affected	Ickenham

2. RECOMMENDATION

Meeting with the petitioners, that the Cabinet Member:

- 1. Listens to their request for an extension to the Ickenham Parking Management Scheme to be introduced in Austin's Lane, Ickenham.**
- 2. Advises the petitioners that the Council intends to review the Ickenham Parking Management Scheme and to formally consult Austin's Lane and other roads in the area in March 2017 on the plans attached as Appendix B.**

Reasons for recommendation

To allow the Cabinet Member to discuss with petitioners their concerns and inform them that the Council already plans to review the parking within their road.

Alternative options considered / risk management

These will be discussed with petitioners.

Policy Overview Committee comments

None at this stage.

3. INFORMATION

Supporting Information

1. A petition with 38 signatures has been submitted to the Council signed by the residents of Austin's Lane, Ickenham. The lead petitioner has made the following statement in a covering email to the petition:

"The Petition to the Council enclosed seeks a Democratic adjustment to the singularly unfair and dangerous exclusion from the Residential Parking Permit Scheme on Austins Lane. The "bump" in the mapped area (also enclosed) eastern boundary appears ingenuous.

This unregulated parking area is now heavily over-used by, and seen as an overflow car park for the TfL Tube and the general area, from within the scheme avoiding second car charges, commuters or shoppers going in to London, and Ickenham visitors squeezed out of regular parking slots. It means that Austins Lane residents (who include shift workers) are forced to park some distance from their dwellings, and that council services (paid for by the same residents) are impeded (dustcarts/road sweeping/drains maintenance), and that emergency/hospital services-in day time cannot move freely.

May we look forward to serious consideration of the issues brought to attention here and to an early resolution to the problems."

2. The location of the boundary of the nearby Ickenham Parking Management Scheme Zone IC2 is indicated on the plan attached as Appendix A. As Austin's Lane is situated on the northern boundary of the scheme, it forms an attractive area for non-residents to park.

3. When the Council initially consulted the residents of Austin's Lane in October 2014, the majority of residents indicated that they did not wish to be included in a possible extension to the Ickenham Parking Management Scheme and preferred the parking in their road to remain as existing. The Council subsequently developed detailed proposals to introduce a scheme in the roads that supported a scheme and this included most of the area surrounding Austin's Lane.

4. Following the above the Council conducted formal consultation to propose an extension to the Ickenham Parking Management Scheme in the majority of roads in the area surrounding Austin's Lane. During this consultation some concerns were raised that parking would be displaced into Austin's Lane if it was not included in the proposed scheme. As a result the Council carried out a further informal consultation with residents of Austin's Lane to see if they would like

to reconsider a scheme in their road. This time the majority of residents that responded supported being included in a possible scheme and subsequently the Council developed detailed proposals for the inclusion of Austin's Lane and several other nearby roads into the scheme.

5. Formal consultation was carried out to introduce an extension to the Ickenham Parking Management Scheme in Austin's Lane in June 2016. As part of the consultation residents were advised that the Council was proceeding with the implementation of the parking scheme in the surrounding roads and the outcome of this consultation would determine if their road would also be included. However, during this consultation the majority of residents who took the opportunity to respond generally did not support the scheme proposed for their road. After consideration of all of the responses received, the Council therefore decided not to include Austin's Lane within the Ickenham Parking Management Scheme, choosing instead to defer the proposals in that road and to review the situation again six months.

6. This petition has been signed by 24 different properties in Austin's Lane which represents approximately 63% of the total number of households in the road. This gives a clear indication that residents would now like to reconsider a parking scheme in their road. The most recent extension to the Ickenham Parking Management Scheme was implemented in September 2016. The Council therefore intends to review the parking in Austin's Lane again as soon as March 2017.

7. It is recommended that if the Cabinet Member feels it is appropriate to do so, the Council could proceed directly with formal consultation to introduce an extension to the Ickenham Parking Management Scheme in Austin's Lane. The previously proposed scheme design should be proposed again as this appears to be the most effective way of maximising parking and maintaining access, attached as Appendix B is are plans of these detailed proposals.

8. In summary the petition from the residents of Austin's Lane has demonstrated that residents appear to now be supportive a parking scheme in their road. The Council has already planned to review the parking in Austin's Lane and so accordingly it is recommended that residents be formally consulted on the same proposals again so that they may reconsider being included in the Ickenham Parking Management Scheme.

Financial Implications

There are none associated with the recommendations to this report, however if the Council were to consider the introduction of parking restrictions in Austin's Lane or any other of the surrounding roads, funding would need to be identified from a suitable source.

4. EFFECT ON RESIDENTS, SERVICE USERS & COMMUNITIES

What will be the effect of the recommendation?

To allow the Cabinet Member to consider the petitioners request and available options the Council have to address these concerns.

Consultation Carried Out or Required

Previously both informal and formal consultations have been carried out with the residents of Austin's Lane. The recommendation of this report is to inform petitioners that the Council

intends to conduct further formal consultation to for a possible extension to the Ickenham Parking Management Scheme in Austin's Lane and the surrounding area again.

5. CORPORATE IMPLICATIONS

Corporate Finance

Corporate Finance has reviewed this report and concurs with the financial implications noted above.

Legal

The decision makers must ensure that there is full consideration of the representations and objections that have been received. In exercising the power to review the Ickenham Parking Management Scheme at Austin's Lane and other roads in the area, the Council have to consider their statutory duty under section 122 of the Road Traffic Regulation Act 1984 to secure the expeditious, convenient and safe movement of vehicular and other traffic. The statutory duty must be balanced with the concerns raised by the objectors.

The Traffic Signs Regulations and General Directions 2002 govern road traffic signs and road markings. If an Order is made, the Council should ensure that the statutory procedures are followed. The consultation and order making statutory procedures that should be followed in this case are set out in The Local Authorities' Traffic Orders (Procedures) (England and Wales) Regulations 1996 (SI 1996/2489).

In relation to the recommendation that statutory consultation is carried out on the proposed review the Ickenham Parking Management Scheme the Council must ensure that the following exercise is undertaken prior to making a traffic regulation order:

- notice of the proposed order must be published in a local newspaper;
- the Council must take such other steps as it may consider appropriate for ensuring that adequate publicity about the order is given to persons likely to be affected by its provisions including where appropriate publicising the order in the London Gazette, display of notice in roads or other places affected by the order or the delivery of notices or letters to premises, or premises occupied by persons which appears to the Council to be likely to be affected by any provision in the order. It is also advisable to display adequate notices in the vicinity of the roads affected by the order.

In considering any consultation responses, the Council must balance the concerns of any objectors with the statutory duty to secure the expeditious, convenient and safe movement of vehicular and other traffic (section 122 Road Traffic Regulation Act 1984).

If specific advice is required in relation to the works, Legal Services should be consulted.

Corporate Property and Construction

None at this stage.

Relevant Service Groups

None at this stage.

6. BACKGROUND PAPERS

Cabinet Member report - Ickenham Parking Management Scheme - Results of informal consultation on a possible extension to the scheme - Published February 2015

Cabinet Member report - Results of statutory consultation for the proposed extension to the Ickenham Parking Management Scheme - Published December 2015

Cabinet Member report - Results of statutory consultation for amendments to an extension to the Ickenham Parking Management Scheme - Published May 2016

Cabinet Member report - Results of statutory consultation for an extension to the Ickenham Parking Management Scheme in Austin's Lane, Sussex Road & Tavistock Road - Published September 2016

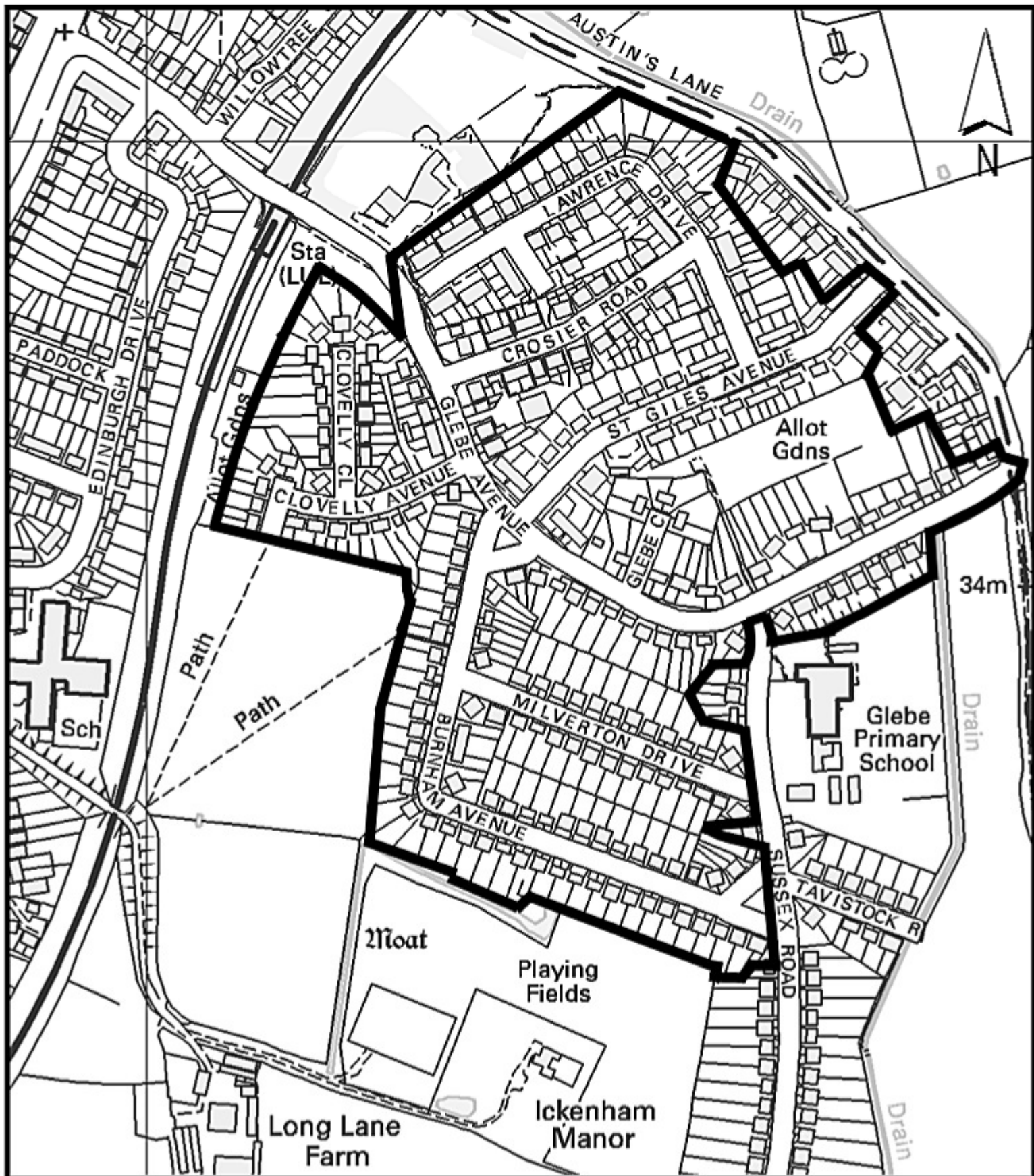

Ickenham Parking Management Scheme
Zone IC2

Appendix A

Date September 2016
Scale 1:4000

 Extent of the Ickenham Parking Management Scheme Zone IC2

Double yellow lines to continue along both sides of Austin's Lane from this point up to the existing restriction near the junction with High Road, Ickenham

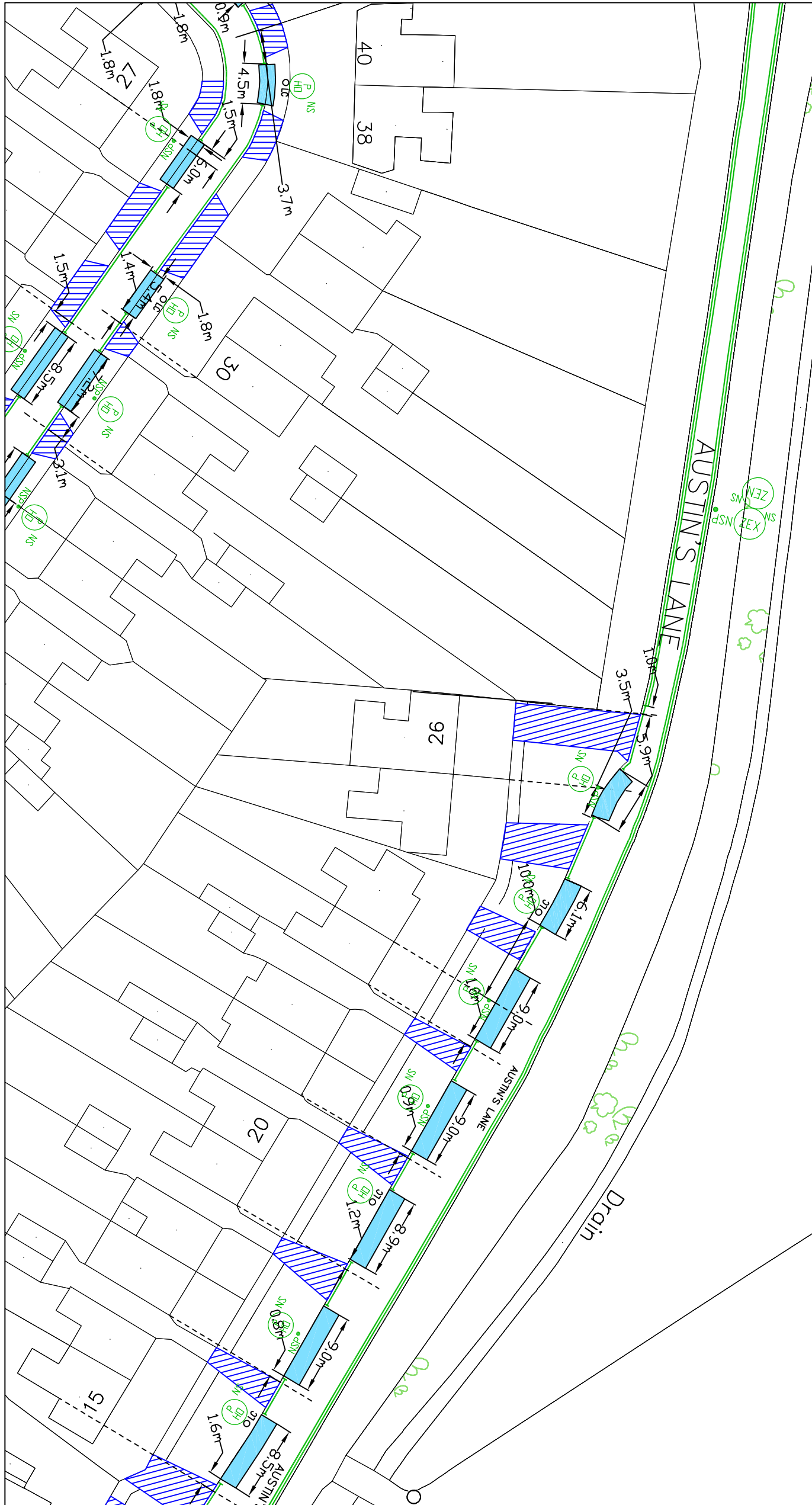
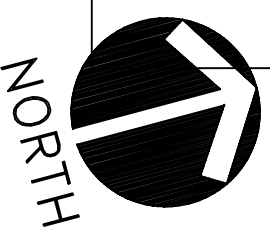

KEY	
	EXISTING YELLOW LINE
	BURN OFF ROAD MARKING
	PROPOSED SINGLE YELLOW LINE
	MON TO FRI 9AM TO 5PM
	PROPOSED DOUBLE YELLOW LINE
	PERMIT HOLDER ONLY BAY
	MON TO FRI 9AM TO 5PM
	CROSSOVER
	SP SIGNPOST
	NSP NEW SIGNPOST
	NS NEW SIGN
	OLC LAMP COLUMN
	PERMIT HOLDER ONLY SIGN
	ZONE ENTRY SIGN
	ZONE EXIT SIGN

This map is based upon Ordnance Survey material with the permission of Ordnance Survey on behalf of the Controller of Her Majesty's Stationary Office. Crown copyright. Unauthorised reproduction infringes Crown copyright and may lead to prosecution or civil proceedings.
London Borough of Hillingdon 100019283 ©2016

HILLINGDON LONDON

TRANSPORT & PROJECTS
RESIDENTS SERVICES DIRECTORATE
Civic Centre, 4th Floor, High Street, Ickenham, Ux8 1UW
Tel: No. 01895 277009/01895 258970

Project
Proposed extension to the Ickenham Parking Management Scheme Zone IC2

Description
Austin's Lane
Sheet 1 of 3

Scale	NTS	Designed	KU	Drawn	KU	Date	09/05/16
-------	-----	----------	----	-------	----	------	----------

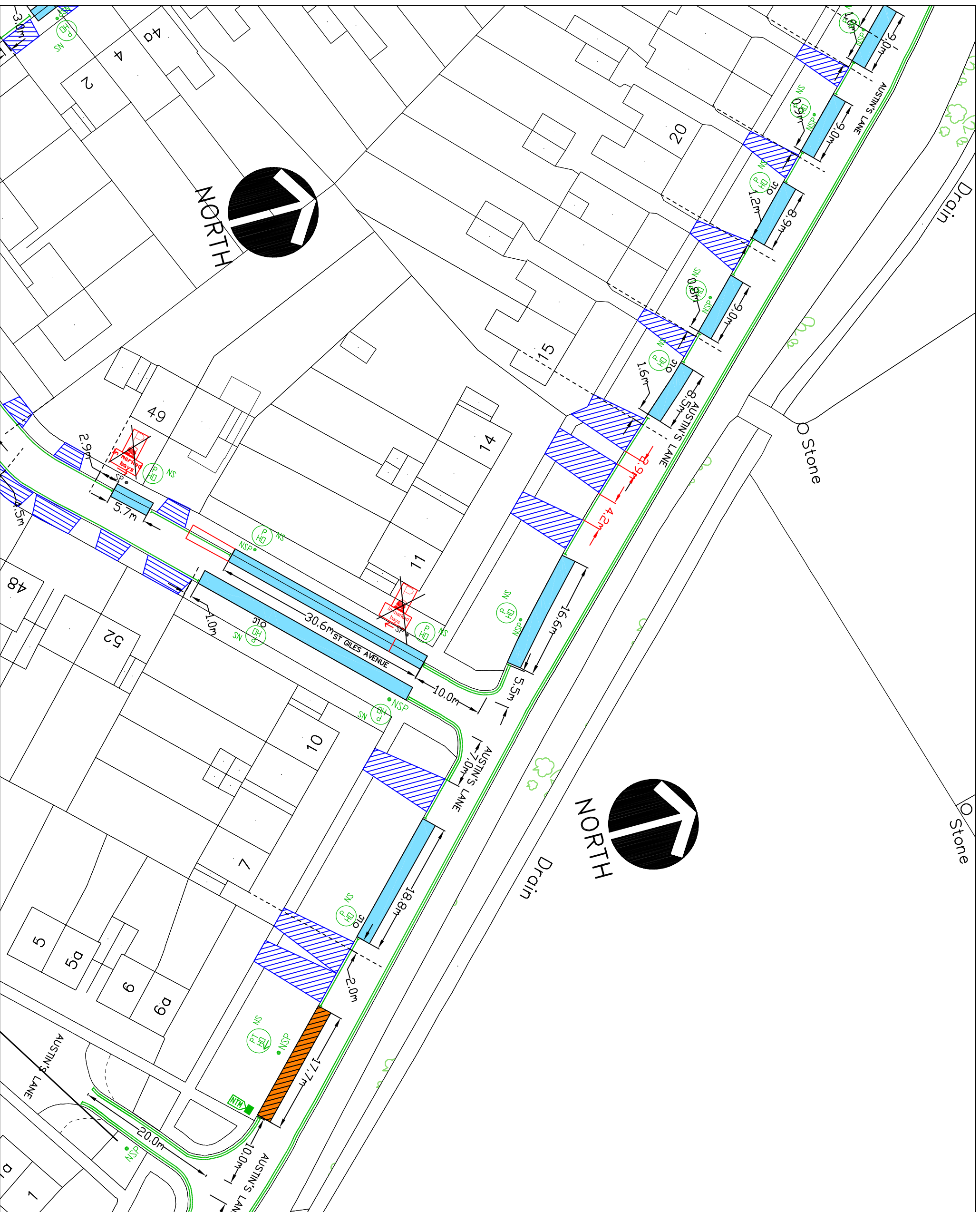

KEY

	EXISTING YELLOW LINE
	BURN OFF ROAD MARKING
	PROPOSED SINGLE YELLOW LINE MON TO FRI 9AM TO 5PM
	PROPOSED DOUBLE YELLOW LINE
	PERMIT HOLDER ONLY BAY MON TO FRI 9AM TO 5PM
	PAY AND DISPLAY OR PERMIT HOLDERS MON TO FRI 9AM TO 5PM
	CROSSOVER
	SIGNPOST
	NEW SIGNPOST
	NEW SIGN
	LAMP COLUMN
	PERMIT HOLDER ONLY SIGN
	ZONE ENTRY SIGN
	ZONE EXIT SIGN
	NEW TICKET MACHINE

This map is based upon Ordnance Survey material with the permission of Ordnance Survey on behalf of the Controller of Her Majesty's Stationary Office. Crown copyright. Unauthorised reproduction infringes Crown copyright and may lead to prosecution or civil proceedings.

London Borough of Hillingdon 100019283 ©2016

HILLINGDON
LONDON

TRANSPORT & PROJECTS
RESIDENTS SERVICES DIRECTORATE
Civic Centre, 4th Floor, Hill Street, Uxbridge, UB8 3UH
Tel: No. 01895 277049/01895 258976

Project
Proposed extension to the
Ickenham Parking Management
Scheme Zone IC2

Description
Austin's Lane
Sheet 2 of 3

Scale	NTS	Designed	KU	Drawn	KU	Date	09/05/16
-------	-----	----------	----	-------	----	------	----------

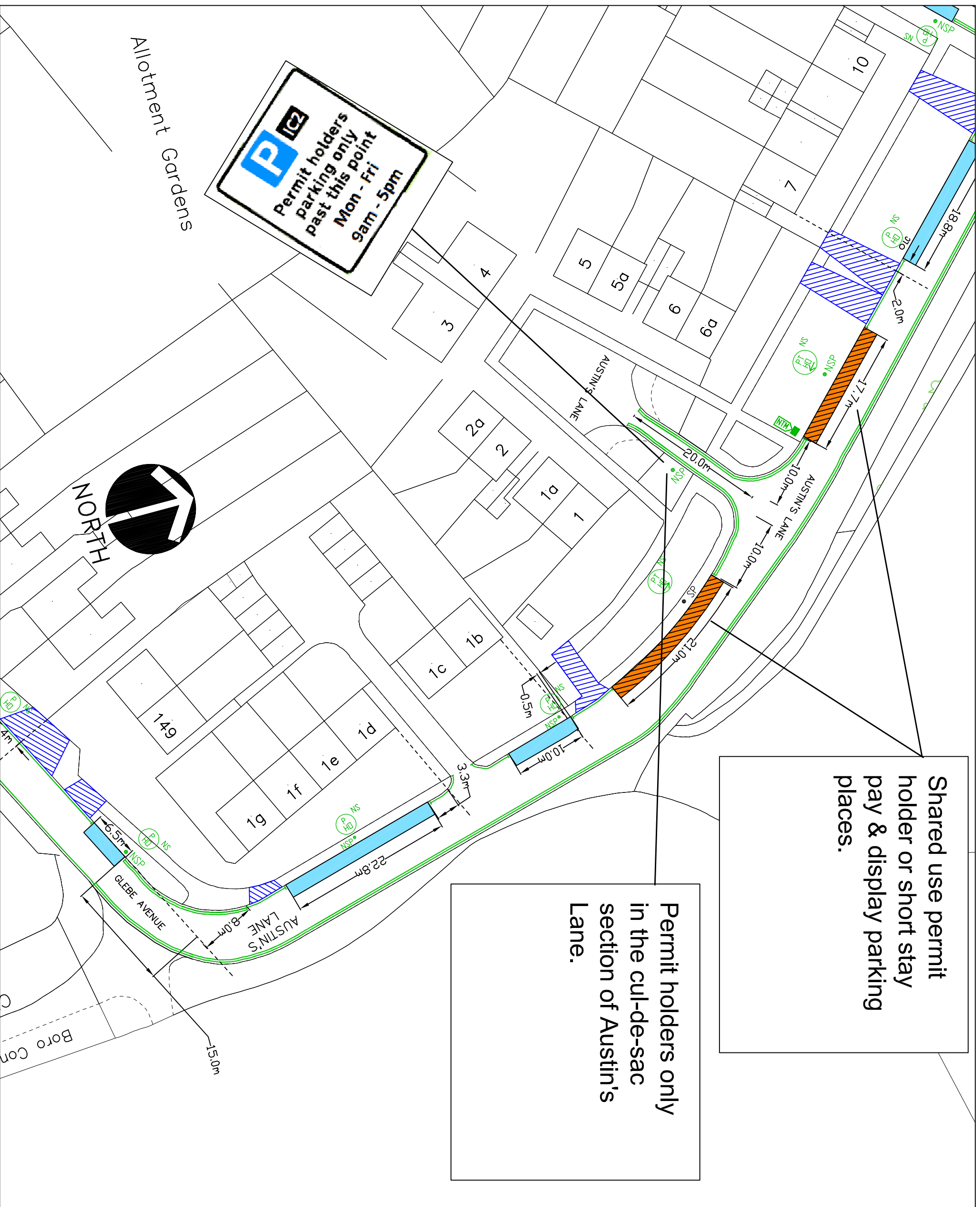

Shared use permit holder or short stay pay & display parking places.

Permit holders only in the cul-de-sac section of Austin's Lane.

KEY	
	EXISTING YELLOW LINE
	BURN OFF ROAD MARKING
	PROPOSED SINGLE YELLOW LINE MON TO FRI 9AM TO 5PM
	PROPOSED DOUBLE YELLOW LINE
	PERMIT HOLDER ONLY BAY MON TO FRI 9AM TO 5PM
	PAY AND DISPLAY OR PERMIT HOLDERS MON TO FRI 9AM TO 5PM
	CROSSOVER SIGNPOST
	NEW SIGNPOST
	NEW SIGN
	NEW TICKET MACHINE
	LAMP COLUMN
	PERMIT HOLDER ONLY SIGN
	ZONE ENTRY SIGN
	ZONE EXIT SIGN

This map is based upon Ordnance Survey material with the permission of Ordnance Survey on behalf of the Controller of Her Majesty's Stationary Office. Crown copyright. Unauthorised reproduction infringes Crown copyright and may lead to prosecution or civil proceedings.
London Borough of Hillingdon 100019283 ©2016

HILLINGDON
LONDON

TRANSPORT & PROJECTS
RESIDENTS SERVICES DIRECTORATE
CWC CENTRE, 4th FLOOR, HIGH STREET, UXTON, OXFORD, OX8 1UW
Tel: No. 01895 277069/01895 288970

Project
Proposed extension to the Ickenham Parking Management Scheme Zone IC2

Description
Austin's Lane
Sheet 3 of 3

Scale	NTS	Designed	KU	Drawn	KU	Date	09/05/16
-------	-----	----------	----	-------	----	------	----------